

# ORDERING INFORMATION

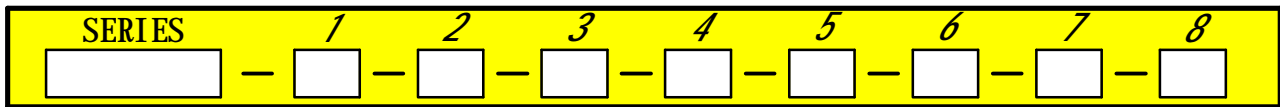
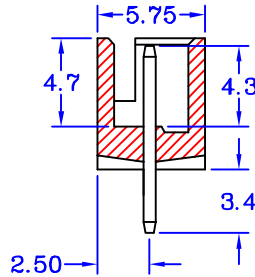
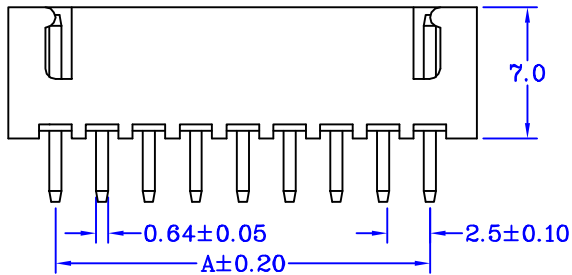
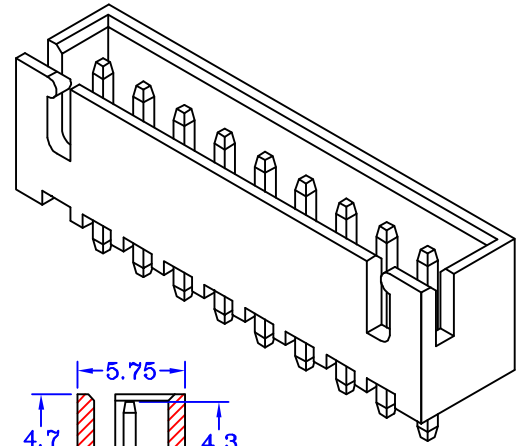
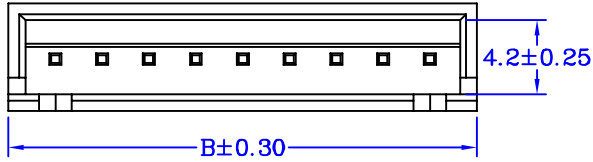

## Series

- PXWXxx : Board to Wire Wafer Pitch 1.25mm Dip Type
- PXWOxx : Board to Wire Wafer Pitch 1.5mm Dip Type
- PXWAxx : Board to Wire Wafer Pitch 2.0mm Dip Type
- PXWBxx : Board to Wire Wafer Pitch 2.5mm Dip Type
- PXWCxx : Board to Wire Wafer Pitch 2.54mm Dip Type
- PXWGxx : Board to Wire Wafer Pitch 3.5mm Dip Type
- PXWDxx : Board to Wire Wafer Pitch 3.96mm Dip Type
- PXWHxx : Board to Wire Wafer Pitch 4.2mm Dip Type
- PXWExx : Board to Wire Wafer Pitch 5.0mm Dip Type
- PXWJxx : Board to Wire Wafer Pitch 5.08mm Dip Type
- PXWFxx : Board to Wire Wafer Pitch 8.0mm Dip Type

## 1. Terminal Type

- S : Straight Termination
- R : Right Angle Termination

## 2. Row Type

- 1 : Single Row
- 2 : Dual Rows

## 3. No. of Contacts

02 ~ 24 Contacts In Total

## 4. Plating Option

- G : Gold Plated
- T : Tin Plated

## 5. Products Logo

- A : Custom-Made
- B : Without Logo ( Standard )

## 6. Insulator Color

- 1 : Black
- 3 : Red
- 4 : White
- 9 : Brown
- 2 : Blue

## 7. Insulator Type

- Blank : Standard Type
- #1 : Fixed Column Base
- #2 : Side Of The Fixed Column

## 8. Cut Pin Location

- Blank : Without Cut Pin (Standard)
- AA ~ZZ : Custom-Made

## EXAMPLE : PXWX01 R 1 05 T B 4

Board to Wire Wafer Pitch 1.25mm Dip Type Serial number X01  
 Right Angle Termination Single Row 5 Pin Tin Plated  
 Without Logo Insulator Color White