

ORDERING INFORMATION

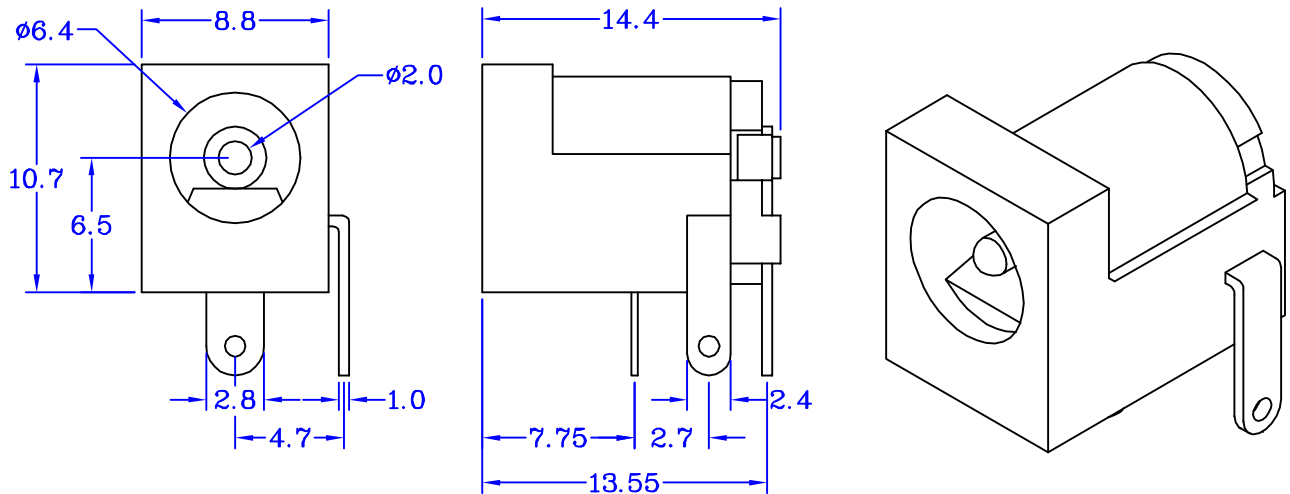

Series	1	2	3	4	5	6
□	□	□	□	□	□	□

- | | |
|--|--|
| Series | DCPJA : DC Power Jack Dip A Type
DCPJB : DC Power Jack Dip B (Side) Type
EPJ : Earphone Jack Dip Type |
| 1. Terminal Type | S : Vertical
R : Right Angle |
| 2. Number of Contacts | 03 : 3 contacts
04 : 4 contacts
05 : 5 contacts |
| 3. Contacts Diameter
(Inside / outside) | $\varphi 1.3$: ($\varphi 1.3$ / $\varphi 4.2$) $\varphi 2.0$: ($\varphi 2.0$ / $\varphi 6.4$)
$\varphi 2.5$: ($\varphi 2.5$ / $\varphi 6.4$) $\varphi 2.5S$: ($\varphi 2.5$ / $\varphi 6.0$)
$\varphi 3.6$: (None / $\varphi 3.6$) |
| 4. Plating Option | T : Tin Plated (Standard) |
| 5. Products Logo | A : With OEM Mark
B : Without Mark (Standard) |
| 6. Insulator Color | 1 : Black (Standard) |

EXAMPLE : DCPJA R 03 $\varphi 2.0$ T B 1
 DC Power Jack Dip A Type Right Angle
 3 contacts Diameter ($\varnothing 2.0$ / $\varnothing 6.4$) Tin Plated
 Without Mark Insulator Color Black

Mbrlinkom Technology Ltd.