

ORDERING INFORMATION

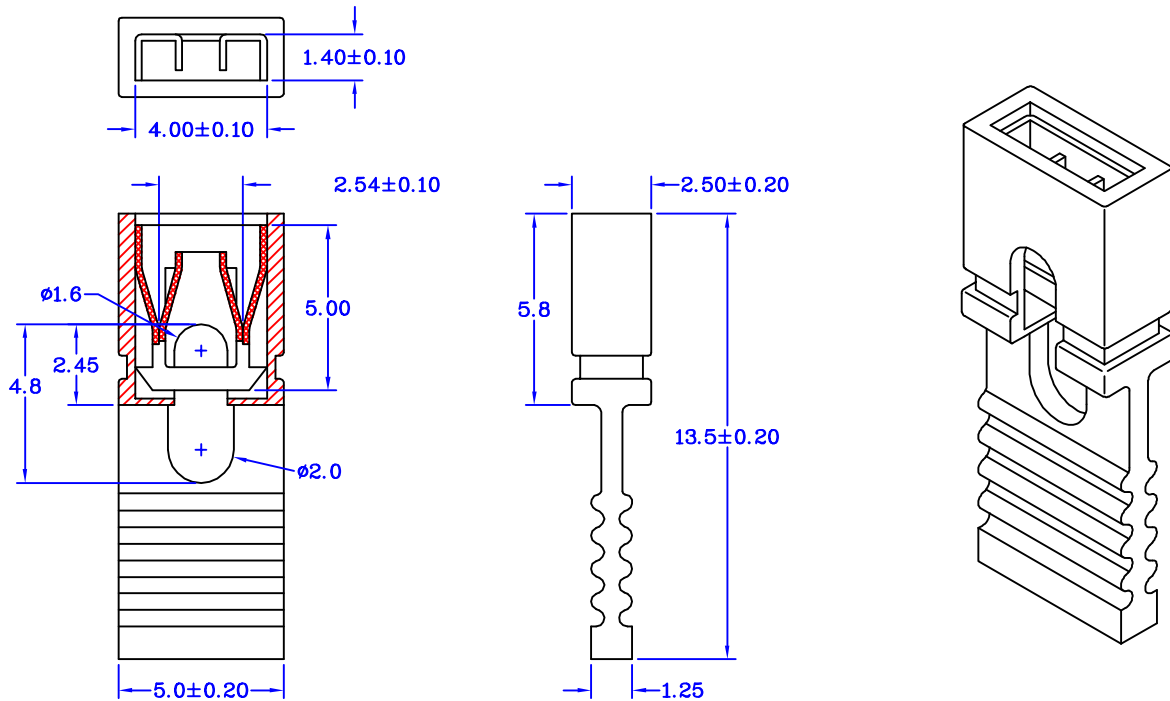

Series	1	2	3	4
[]	[]	[]	[]	[]

- Series**
- MSA : Pitch 2.54mm Mini Jumper Close Type (6mm)
 - MSB : Pitch 2.54mm Mini Jumper Open Type (6mm)
 - MSC : Pitch 2.54mm Mini Jumper Open Type (4.5mm)
 - MSD : Pitch 2.54mm Mini Jumper Close Type (8mm)
 - MSE : Pitch 2.54mm Mini Jumper Open Type (8mm)
 - MSS : Pitch 2.54mm Mini Jumper Handle Type (13.5mm)
 - HMSA : Pitch 2.0mm Mini Jumper Close Type (4.95mm)
 - HMSB : Pitch 2.0mm Mini Jumper Open Type (3.5mm)
- 1. No. of Contacts**
- | | | | | | |
|----|---------|---------|---------|----------|---------|
| 02 | 04(2x2) | 06(2x3) | 08(2x4) | 10(2x5) | 12(2x6) |
| | 14(2x7) | 16(2x8) | 18(2x9) | 20(2x10) | |
- 2. Plating Option**
- T : Tin Plated
 - G : Gold Plated
- 3. Products Logo**
- A : Custom-Made
 - B : Without Logo (Standard)
- 4. Insulator Color**
- | | |
|------------------------|-----------|
| 1 : Black (Standard) | 2 : Blue |
| 3 : Red | 4 : White |
| 5 : Yellow | 6 : Green |
| 7 : Grey | |

EXAMPLE : MSS 02 G B 1

Pitch 2.54mm Mini Jumper Handle Type 2 pin
Gold Plated Without Logo Insulator Color Black

Mbrlinkom Technology Ltd.