

# ORDERING INFORMATION

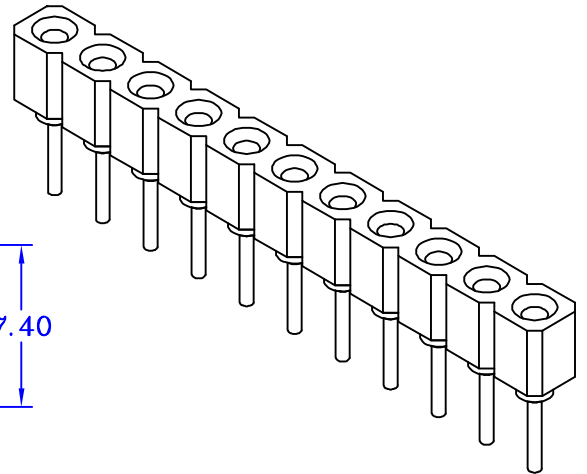
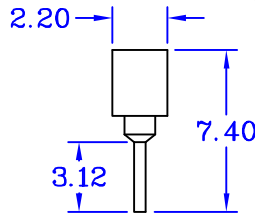
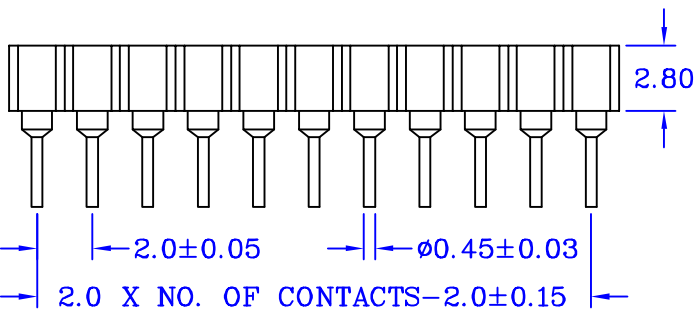
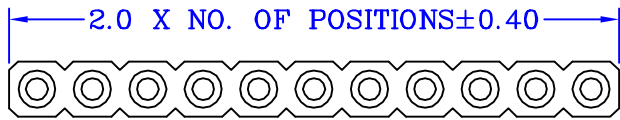

Series	1	2	3	4	5	6	7
<input type="text"/>	<input type="text"/>	<input type="text"/>	<input type="text"/>	<input type="text"/>	<input type="text"/>	<input type="text"/>	<input type="text"/>

- Series**
- PR : Pitch 2.54mm Sip Socket Straight Termination
  - RPR : Pitch 2.54mm Sip Socket Right Angle Termination
  - HPR : Pitch 2.0mm Sip Socket Straight Termination
- 1. Row Type**
- 1 : Single Row
  - 2 : Dual Rows
- 2. No. of Contacts**
- Single Row : 02 ~ 40 Contacts
  - Dual Rows : 04 ~ 80 Contacts In Total
- 3. Plating Option**
- S : Selective Plated ( Standard )
  - G : Gold Plated
  - T : Tin Plated
- 4. Products Logo**
- A : Custom-Made
  - B : Without Logo ( Standard )
- 5. Insulator Color**
- 1 : Black ( Standard )
- 6. Pin Dip Length**
- Blank : L00 ( Standard Length )
  - L01 ~ L99 : Custom-Made
- 7. Insulator Length**
- Blank : P0 ( Standard Length )
  - P1 ~ P99 : Custom-Made

**EXAMPLE : HPR 1 20 S B 1**  
 Pitch 2.0mm Sip Socket Straight Termination  
 Single Row 20 Pin( 1 x 20 Pin ) Selective Plated Without Logo  
 Insulator Color Black Pin Dip Length ( Standard Length )  
 Insulator Length ( Standard Length )

**Mrlinkom Technology Ltd.**